

INSTALLATION INSTRUCTIONS

4160

97 – 02 Ford Expedition

Parts List :

QTY	(1) Hardware kit including :	
(1) Sidebar set (Driver & Passenger)	(4) 1/2 x 2" Flat head bolts	(4) 3/8" Lock washers
(2) Front mounting brackets	(4) 1/2 x 4" Hex head bolts	(8) 3/8" Lock nuts
(2) Front auxiliary mounting brackets	(2) 1/2 x 2" Hex head bolts	(8) 1/4 x 1" Hex head bolts
(2) Rear mounting brackets	(12) 1/2" Flat washers	(8) 1/4" Flat washers
	(6) 1/2" Lock washers	(8) 1/4" Lock washers
	(6) 1/2" Hex nuts	(8) 1/4" Hex nuts
	(2) 3/8 x 5 1/2" Threaded rod	
	(2) 3/8" Flat washers	

Tools Required :

3/4" Socket	3/4" Wrench	7/16" Socket	5/16" Allen wrench
9/16" Socket	9/16" Wrench	7/16" Wrench	Ratchet

Instructions :

Approximated installation time: 30 min.

1. Read and understand instructions completely before beginning installation.
2. Sidebar set consist of a driver and passenger side. The bended leg is the front leg. Be sure to determinate the correct side before installation.
3. Secure the front and rear mounting brackets to the front and rear of the sidebar using 1/2 x 2" flat head bolts. Hand tighten.
4. Place sidebar up to the vehicle and align the rear mounting bracket with the hole in the leaf spring bracket and the front mounting bracket with the two existing holes in the vehicle frame and tighten the 1/2 x 2" flat head bolts until snug.
5. Attach the rear mounting bracket to the leaf spring bracket using a 1/2 x 2" hex head bolt, 1/2" flat & lock washers and hex nut.
6. Attach the front mounting bracket to the vehicle frame using 1/2 x 4" hex head bolts, flat & lock washers and hex nuts. *Note:* On some vehicles it will be necessary to loosen one of the wire harness located on the vehicle frame to allow the front mounting bracket to fit up to the vehicle frame existing holes correctly. The wire harness can be relocated to the small hole in the front mounting bracket.
7. To install front auxiliary mounting bracket, locate the large hole that will be covered by black tape or a rubber plug and remove it. Attach the support bracket to the inside of the rocker panel on the vehicle using 1/4 x 1" hex head bolts, flat & lock washers and hex nuts.
8. Insert the 3/8 x 5 1/2" threaded rod through the hole in the sidebar and the hole in the rocker panel directly above the sidebar and secure into place using 3/8" flat & lock washers and lock nuts.
9. Make any final adjustments to the alignment of the sidebar and tighten all bolts. Repeat for the opposite side.
10. You may need to periodically re-tighten the bolts.

Assembly Diagram :

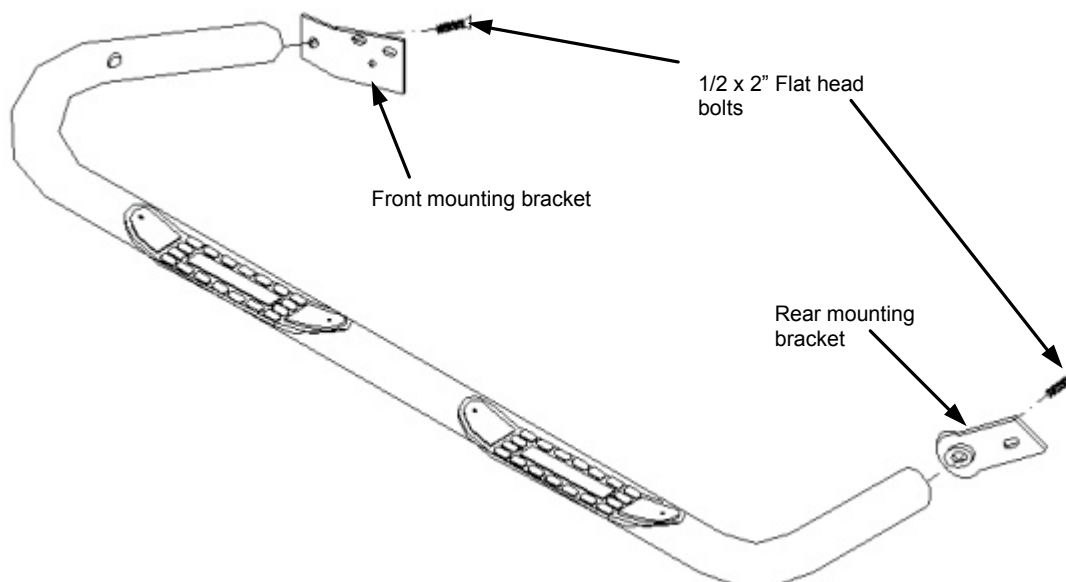

INSTALLATION INSTRUCTIONS

4160

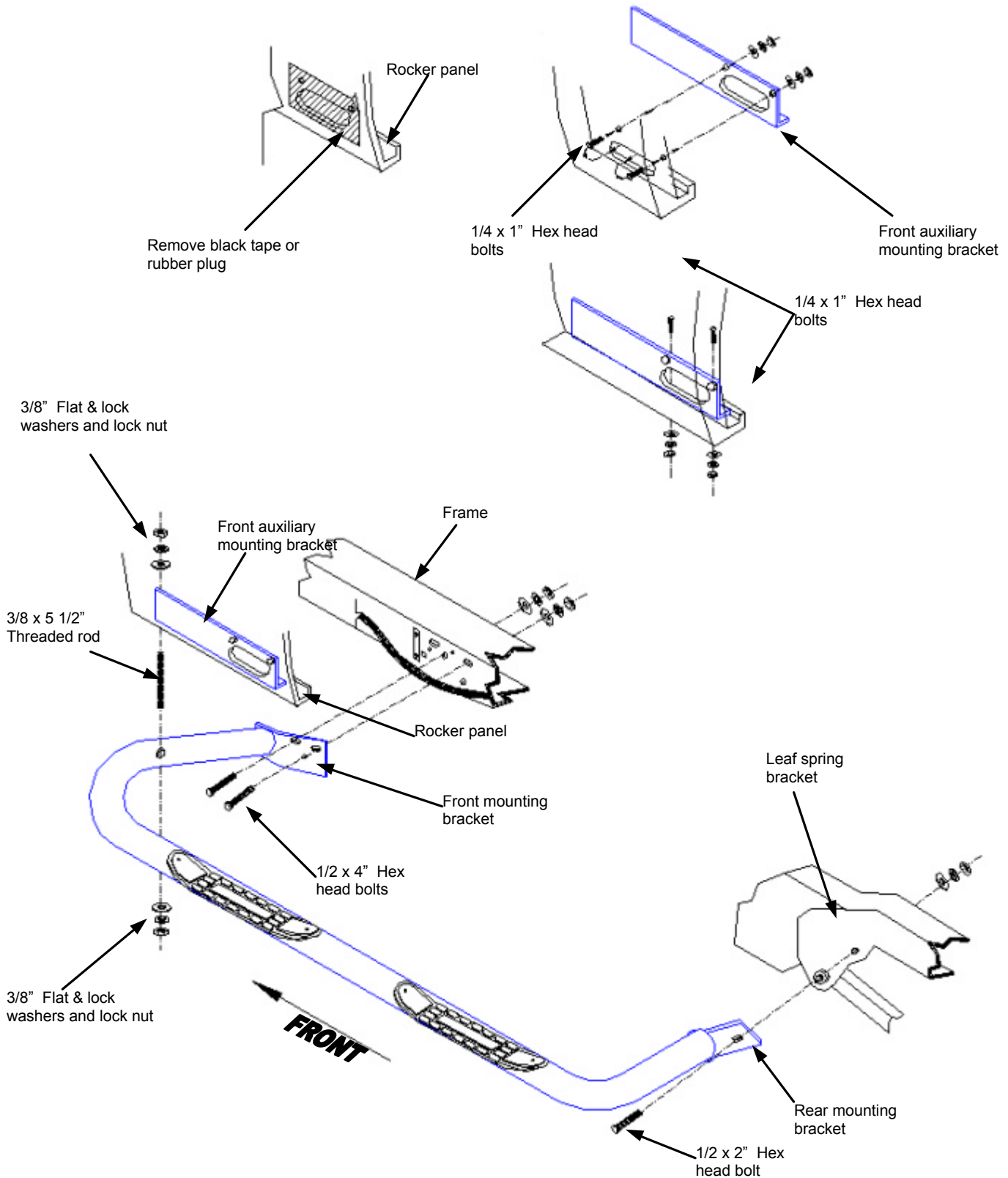

Cleaning and care instructions :

Protect the finish with a non-abrasive automotive wax, (e.g. Pure Carnauba) on a regular basis. The use of any soap, polish, or wax that contains an abrasive is detrimental to the finish, as the compounds scratch the finish and cause corrosion.